

95 GRESHAM STREET LONDON EC2

Fully fitted 'Plug
and Play' space in
the City of London.

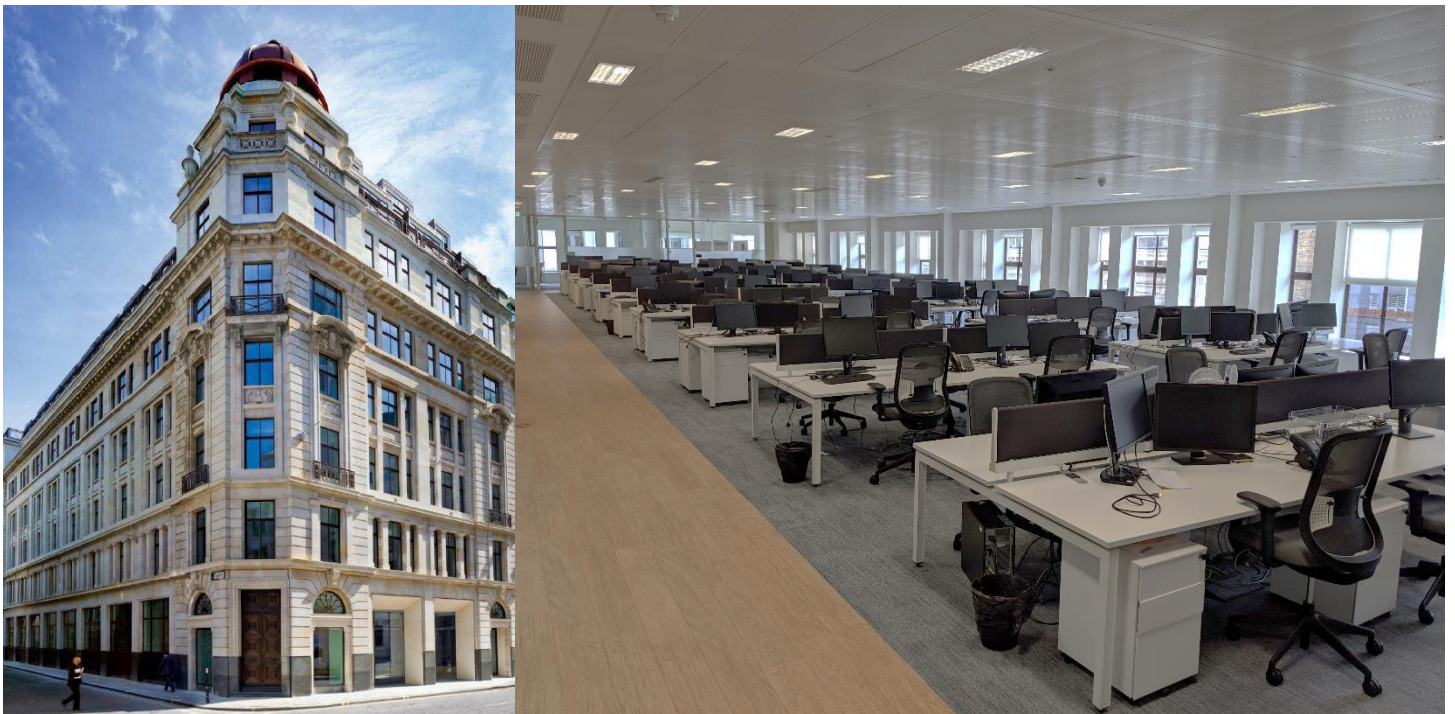

Summary

4th Floor

5,063 Ft² Approx.

Contact us

Viewing is strictly by prior appointment
with Colliers International through:
020 7487 1900

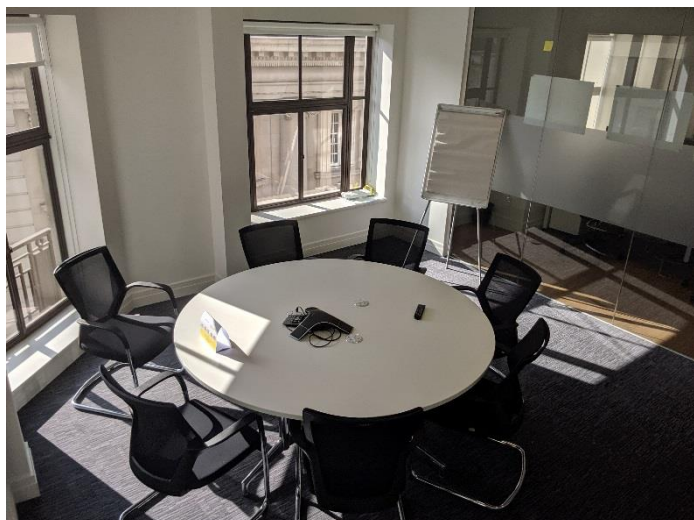

AMENITIES

- Plug and Play office
 - o 72 Desks
 - o Pantry/common room
 - o 4 Meeting rooms
- High quality fit-out offering pre-installed desks and meeting rooms
- 24 Hour Access
- Showers, changing rooms, lockers and bicycle racks
- Male & Female WC's
- High quality reception with commissionaire services

FLOOR AREAS & OUTGOINGS

Floor / Unit	Ft ² Approx.	Rent /Ft ²	Service Charge /Ft ²	Rates /Ft ²	Availability / Status
4 th	5,063	£55.00 (short-term rent)	£11.11	£26.29	Available

*Prospective tenants are advised to confirm any rating liability directly with the Local Authority

LEASE TERM

Sub-lease available until April 2020

Or

Extended sub-lease available until May 2027 (terms to be agreed)

VAT

The property is elected for VAT.

LEGAL COSTS

Each party to bear their own legal costs associated with this transaction.

FLOOR PLAN

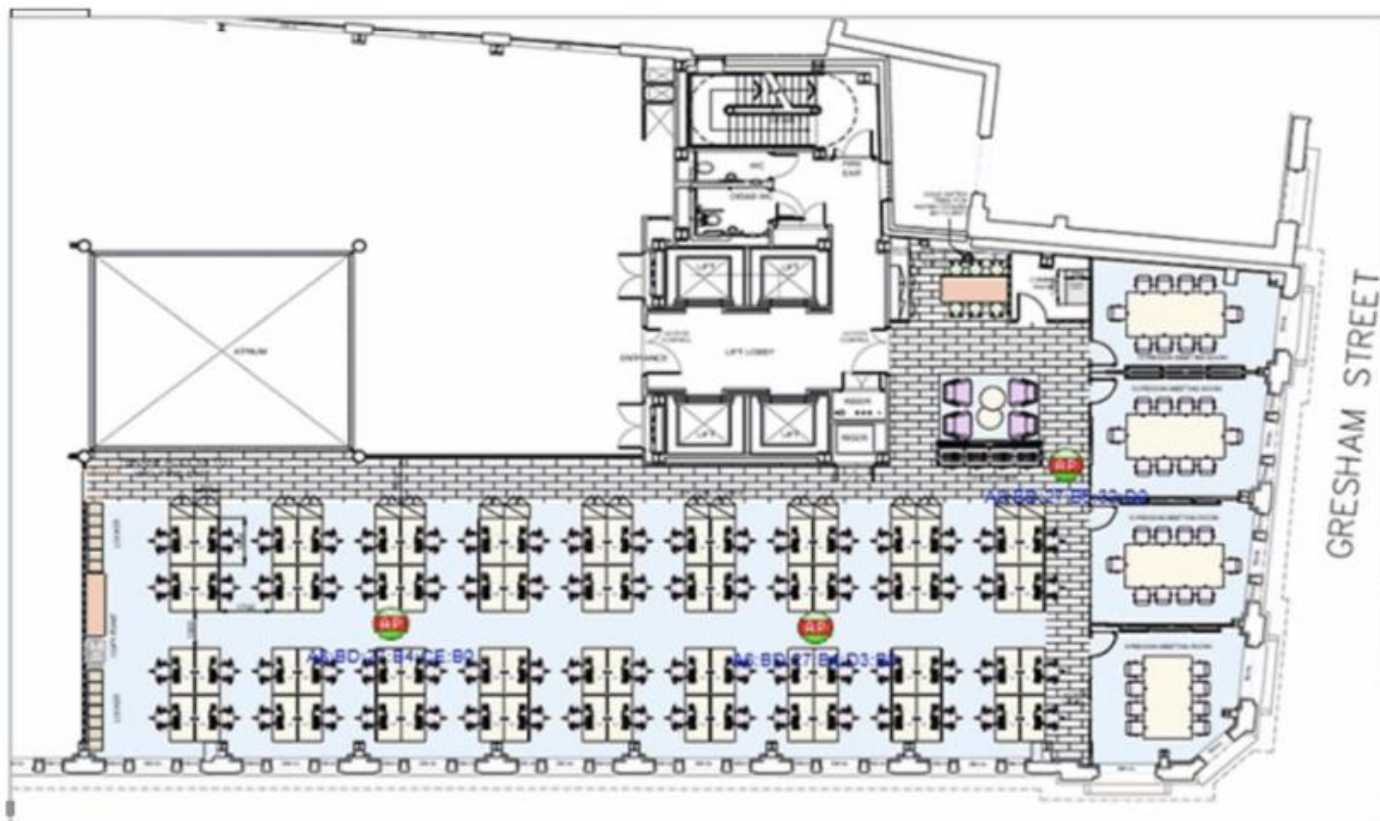



CONTACT US

All appointments to view must be arranged via sole agents, Colliers International through:

Alfie John
Alfie.John@colliers.com
07802 338297

Henry Peto
Henry.Peto@colliers.com
07957 372563

35 King Street, London
EC2V 8EH, United Kingdom

collierslondon.com
020 7487 1900